

Steel Extended
Contact Bearing Stages

Stainless Steel Extended
Contact Bearing Stages

Aluminum Stages

Rotation Stages

Goniometers

Rack & Pinion
Dovetail Stages

Preset Dovetail Stages

Leadscrew Slides

Tilt Platforms

OEM Slides

Accessories

Rotation Stages

- Continuous 360 degree rotation
- Fine adjustment by micrometer
- Concentricity <50microns
- Compatible with linear translation stages
- Five sizes cover most applications
- Inch and metric mounting



Rotation stages permit the precise angular adjustment of components. These stages use plain brass bearings to provide coarse adjustment over a full 360 degree circle. A scale around the circumference provides an indication of the angle. Once set approximately in place the stage may be locked by means of a clamp screw and then fine adjusted by a micrometer (fine pitch screw is used for the 25mm stage). The sizes of these stages are such that they may be mounted together with translation stages to form compound motion devices. The largest stage we offer has a diameter of 160mm and a 102mm central aperture. The 120mm stage has a 62mm central aperture so it can be mounted with an optical beam passing through its center. The 90mm stage will accept a 65mm linear stage and the 65mm rotation stage can be mounted on top of a 65mm translation stage. The 40mm stage is ideal for OEM applications. The 25mm stage works well with the mini-system described on page 307. The 160, 120 and 90mm stages utilize crossed roller bearings for high load capacity.

Part No. 124-0210/0215

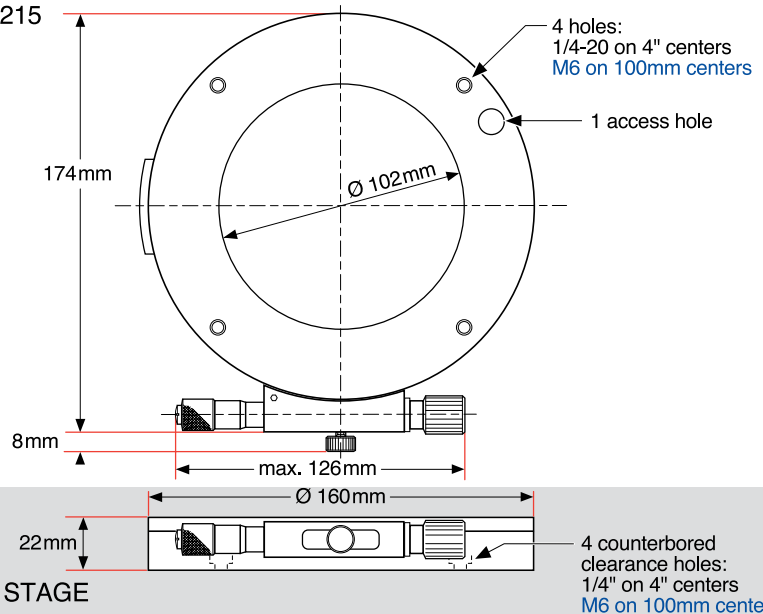

ORDERING
&
TECHNICAL SUPPORT
(949) 851-5881
FAX (949) 851-5058
E-MAIL
sales@optosigma.com
WEB
www.optosigma.com



Steel Extended
Contact Bearing Stages

Steel Extended
Contact Bearing Stages

Aluminum Stages

Rotation Stages

Goniometers

Rack & Pinion
Dovetail Stages

Preset Dovetail Stages

Leadscrew Slides

Tilt Platforms

OEM Slides

Accessories



Part No. 124-0090/0095

4holes:
1/4-20 on 2"centers
M6 on 50mm centers

Ø11 access hole

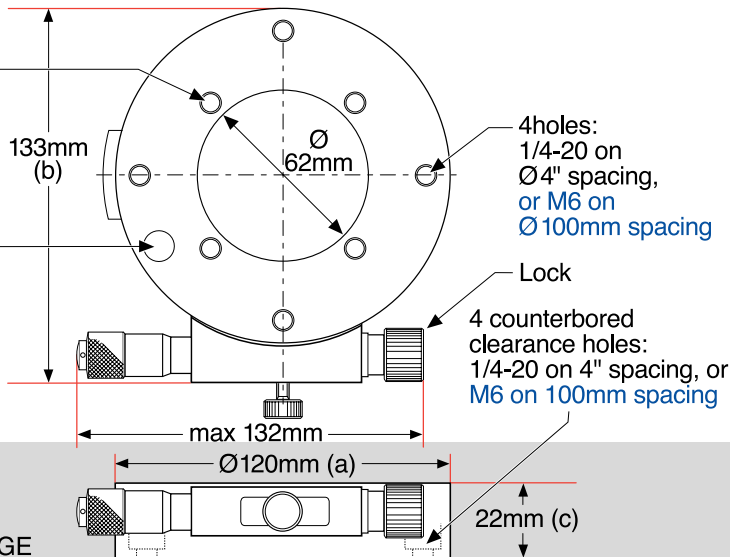

Part No. 124-0070/0075

Ø11 access hole

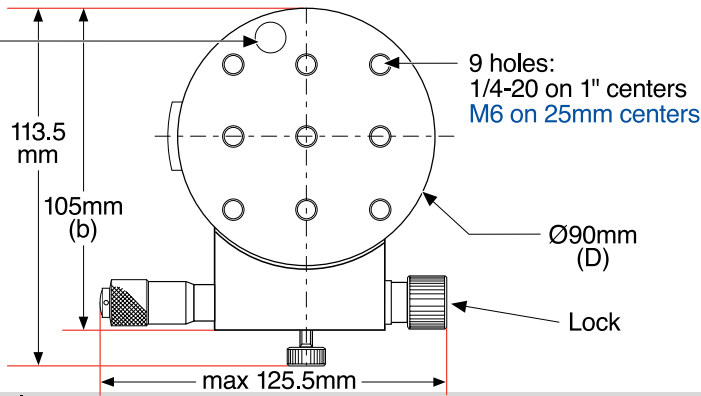

4 counterbored clearance holes:
1/4-20 on 2" centers
M6 on 50mm centers

90mm ROTATION STAGE

Part No. 124-0050/0055

4 holes:
1/4-20 on Ø2" spacing
M6 on Ø50mm spacing

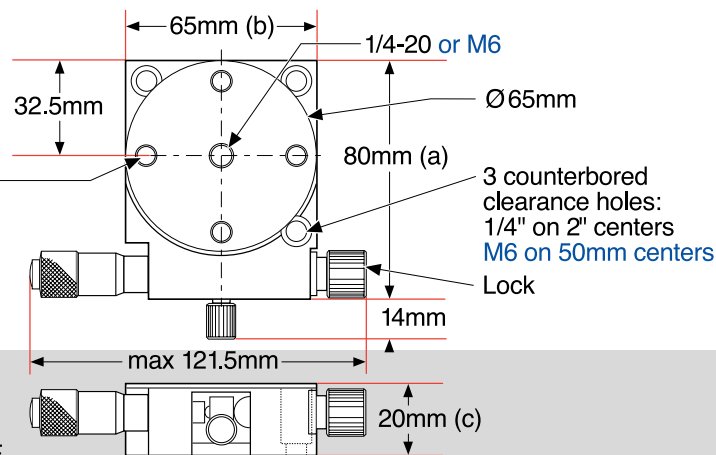

ORDERING
&
TECHNICAL SUPPORT
(949) 851-5881
FAX (949) 851-5058
E-MAIL
sales@optosigma.com
WEB
www.optosigma.com



MANUAL POSITIONERS

Steel Extended
Contact Bearing Stages

Stainless Steel Extended
Contact Bearing Stages

Aluminum Stages

Rotation Stages

Goniometers

Rack & Pinion
Dovetail Stages

Preset Dovetail Stages

Leadscrew Slides

Tilt Platforms

OEM Slides

Accessories

Part No. 124-0030/0035

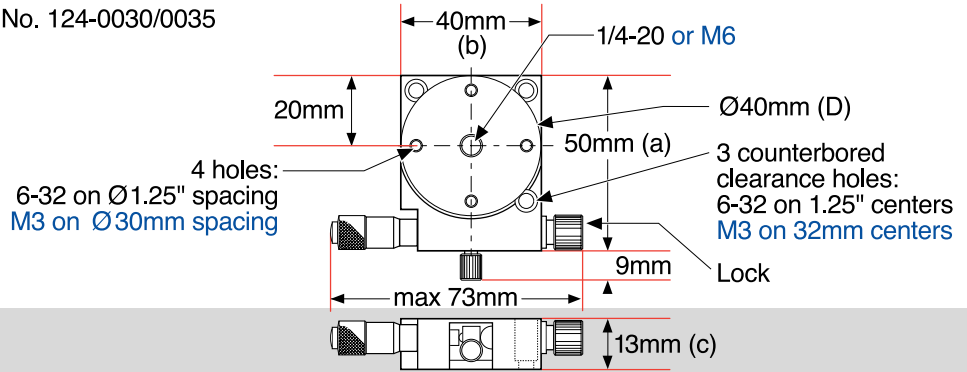

40mm ROTATION STAGE

Part No. 124-0010

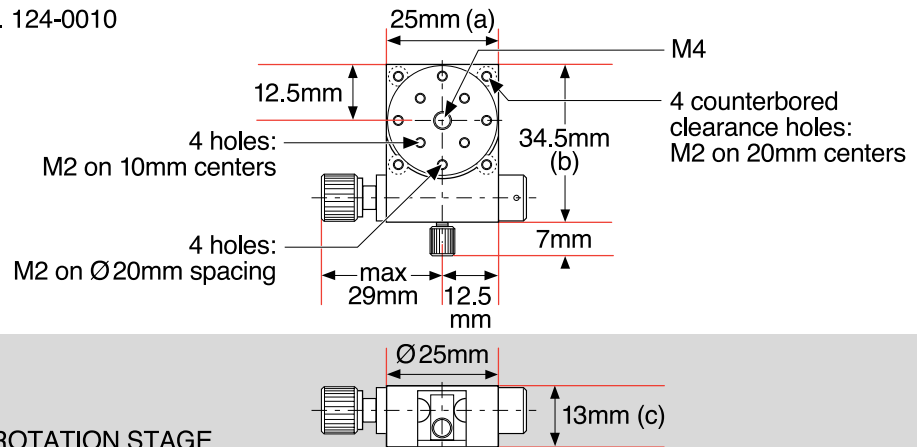

25mm ROTATION STAGE

Specifications & Tolerances

Dimensions: $\pm 0.2\text{mm}$

Material: Brass

Concentricity: $< 0.05\text{mm}$

Finish: Black chrome

Parallelism: $< 0.05\text{mm}$

Rotation Stages

INCH METRIC

Outer Diameter, d (mm)	Dimensions, a x b (mm)	Height, c (mm)	Vernier Resolution	Minimum Incremental Motion	Fine Adjustment Range (deg)	Load Capacity (kg)	Price	PART NUMBER	PART NUMBER
160	160 x 174.0	22	5'	20"	± 3	100		124-0210	124-0215
120	120 x 133.0	22	5'	20"	± 4	100		124-0090	124-0095
90	90 x 103.0	22	5'	30"	± 5	80		124-0070	124-0075
65	65 x 80.0	20	20'	30"	± 5	7		124-0050	124-0055
40	40 x 50.0	13	20'	30"	± 5	5		124-0030	124-0035
25	25 x 34.5	13	20'	1'	± 5	3		-	124-0010