

Rod Mounting Systems

- Damped stainless steel rods for greater stability
- Compatible with existing 1.5 inch systems
- Precision adjustable mounts
- Superior beamsteering system

These 1.5 inch diameter damped steel rods provide a very stable and vibration free method of mounting laser components. Both the rods and the mounts are completely compatible with most existing rod mount systems. Our mounts incorporate precision adjustment mechanisms which are easy to use yet very stable once set. The tilt mount is made to accept a range of replaceable OneTouch™ mirror holders. The beam steering units provide all essential features and operate in such a way as to maintain the beam centerline.



Specifications & Tolerances

Dimensions: $\pm 0.2\text{mm}$

Angular adjustment precision: Coarse, 10arcmin
Fine, 20arcsec

Material: Rods, Stainless steel
Mounts, Aluminum

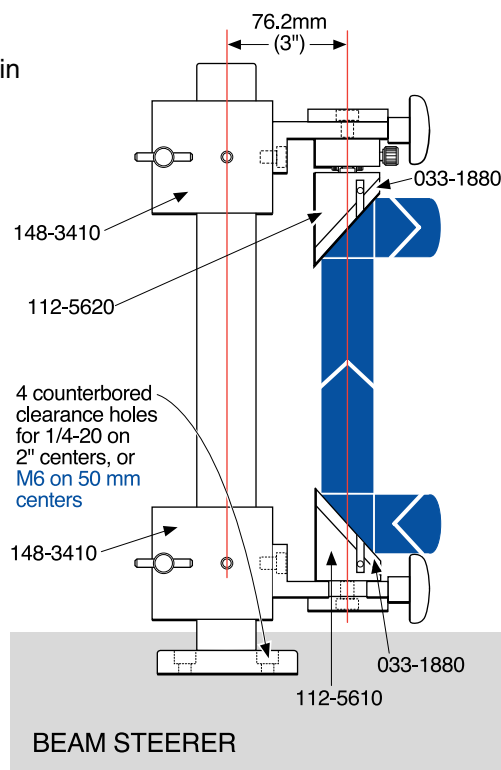
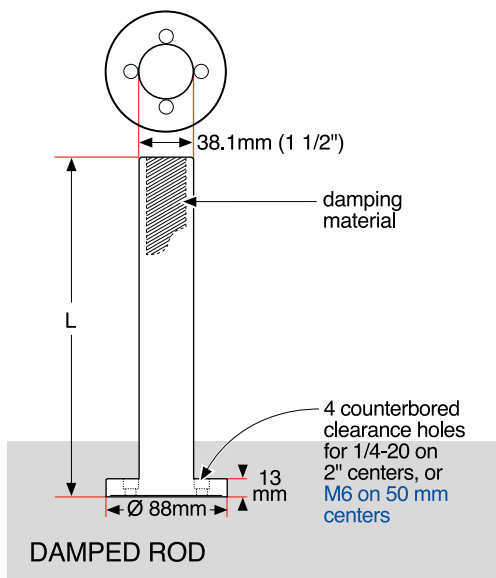

ORDERING
&
TECHNICAL SUPPORT
(949) 851-5881
FAX (949) 851-5058
E-MAIL
sales@optosigma.com
WEB
www.optosigma.com

- Mirror Mounts
- Optic Holders
- Optical Baseplates
- Optical Rails and Carriers
- Bases
- Rod Mounting Systems
- Post, Post Holders, Clamps

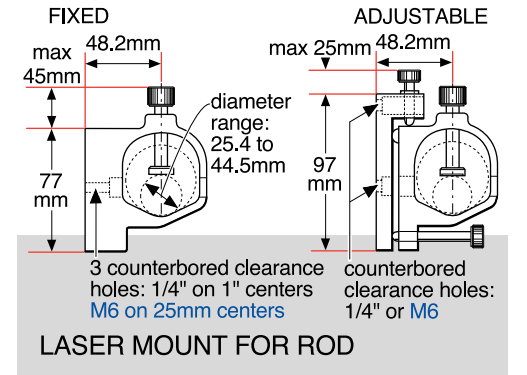
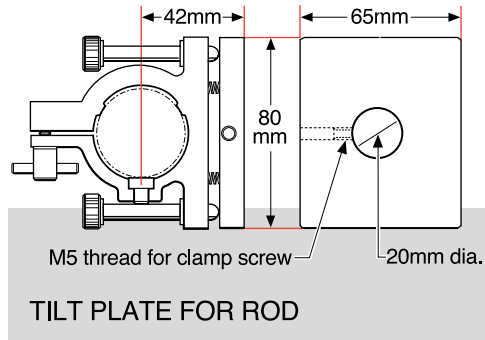
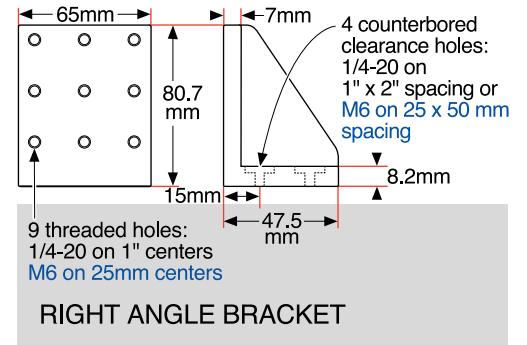
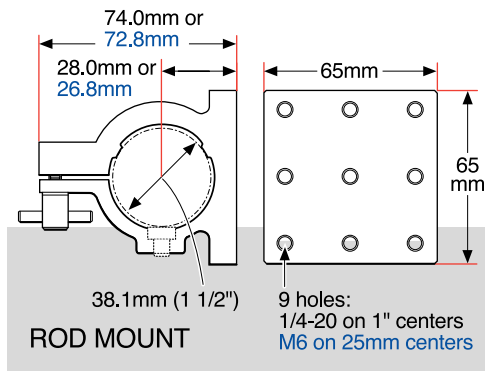

Rod Mounts

Item	Length, L (inches) (mm)	Price	INCH	METRIC
			PART NUMBER	PART NUMBER
Damped Rod	7.0 177.8		148-3310	148-3315
Damped Rod	14.0 355.6		148-3320	148-3325
Rod Mount	- -		148-3410	148-3415
Angle Bracket	- -		148-3450	148-3455
Tilt Mount	- -		112-5630	112-5630
Laser Mount, Fixed	- -		116-0070	116-0075
Laser Mount, Adjustable	- -		116-0080	116-0085

OneTouch™ Mirror Adapters for Tilt Mount

Mirror Diameter (inches)	(mm)	Price	PART NUMBER
1.0	25.4		112-5631
1.5	38.1		112-5632
2.0	50.8		112-5633

Beam-steerers

Item	Price	INCH	METRIC
		PART NUMBER	PART NUMBER
Mirror for beam-steerer - (Protected Aluminum)		033-1880	033-1880
Beam-steerer (coarse)		112-5610	112-5615
Beam-steerer (fine)		112-5620	112-5625
Beam steering assembly complete*		148-3500	148-3505

*Consists of a 14 inch damped rod, two rod mounts, one coarse beamsteerer, one fine beamsteerer and two mirrors.

Precision Beam Steering Assembly

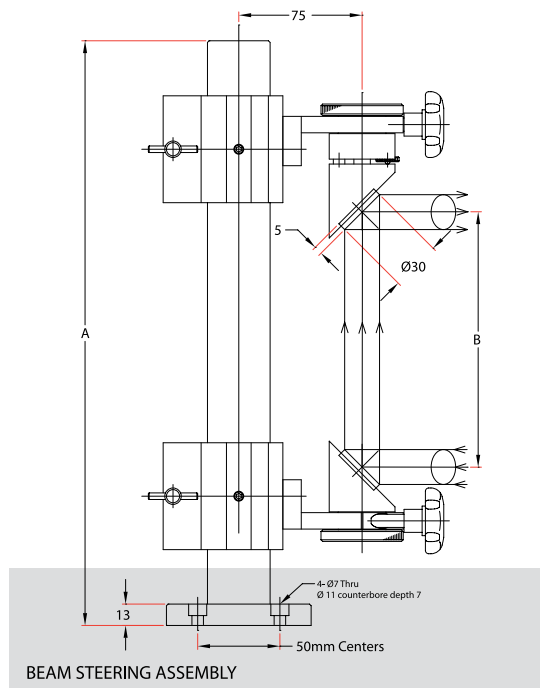

- Mirror Mounts
- Optic Holders
- Optical Baseplates
- Optical Rails and Carriers
- Bases
- Rod Mounting Systems
- Post, Post Holders, Clamps

Precision Beam Steering Assembly

Optic Size		A (mm)	Adjustment Height (mm)	Price	PART NUMBER
Diameter (mm)	Thickness (mm)				
30	5	177.8	33-40		148-3515
30	5	355.6	33-220		148-3525

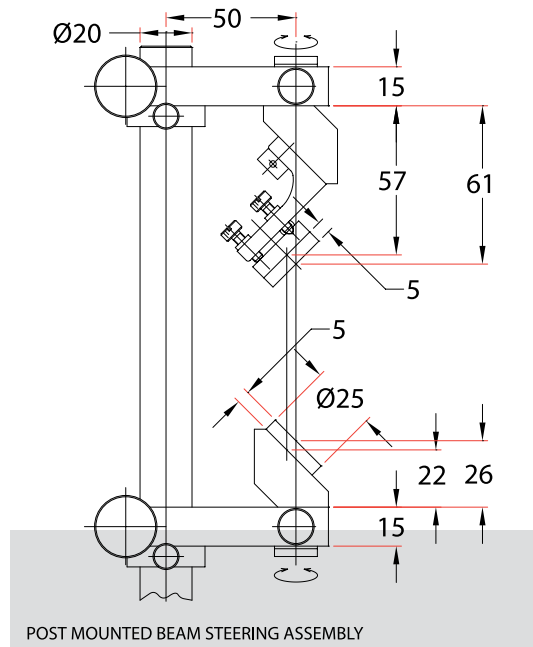

Beam Steering Mounts for 20mm Posts

Optic Size (mm)	Thickness (mm)	Price	PART NUMBER
25 x 25, Ø25	5		112-5627

ORDERING & TECHNICAL SUPPORT
 (949) 851-5881
 FAX (949) 851-5058
 E-MAIL sales@optosigma.com
 WEB www.optosigma.com

